

MATERIALE:
 Beton de egalizare C12/15 CEM II/A-S 32.5 N ; sort 0-31; A/C: 0.75 ;
 Beton armat de monolitizare C30/37 CEM III/A-S 42.5 N; sort 0-16; A/C : 0.55;
 Mortar M100-T
 Armatura Bst500
 Clasa de expunere: XC4 , XD3 , XF4
MATERIALS:
 Equalization concrete C12/15 CEM II/A-S 32.5 N ; sort 0-31; A/C: 0.75 ;
 Reinforced concrete C30/37 CEM III/A-S 42.5 N; sort 0-16; A/C : 0.55;
 Mortar M100-T
 Reinforcement Bst500
 Exposure class: XC4 , XD3 , XF4

Toate tipurile de oțel (în special Bst 500) vor avea obligatoriu clasa de ductilitate C.
 All types of steel (especially Bst 500) will mandatory have the ductility class C.
NOTA:
 In situatia demontarii prefabricatelor din spre linie pentru executarea lucrarilor la linie
 cu masini grele de cale se va aplica urmabarea tehnologie:

1. Se deconecteaza asfaltul in zona monolitizarii dntre prefabricate (DP1)
2. Se demoleaza betonul de monolitizare
3. Se taie armaturile in zona centrata a monolitizarii (la min.1.50m de la marginea peronului)
4. Se demonteaza prefabricatele si se depoziteaza pe cel care nu se demonteaza)
5. Se executa lucrarile la cale
6. Se reface peronul prin montarea prefabricatelor pe pozitia initiala
7. Pe masura ce se monteaza elementele prefabricate de peron se asigura continuitatea armaturilor, laiate in faza 3, cu eclise din Bst500 Ø10mm l=250mm sudate
8. Se monolitizeaza cu beton C30/37 zona demolata si se reface asfaltul decopantat.

NOTE:
 The following technology will be applied in case when the prefabricated elements from the line will be removed in order to execute the line works with heavy track machines.

1. The asphalt uncovering in the concrete cast in position area between prefabricated elements (DP1)
2. Removing the cast-in-place concrete
3. Cutting the reinforcements in the central area of the concrete cast in position (at min.1.50 m from the platform edge)
4. Removing the prefabricated elements and storing them in the same section on the platform exterior side (the removed prefabricated unit is stored on the one which is not removed)
5. Track works execution
6. Renewing the platform by mounting prefabricated elements on the initial position
7. While mounting the prefabricated elements on the platform it is ensured the continuity of reinforcement that were cut at point 3, by help of Bst500 welded fishplates having Ø 10mm and l = 250 mm
8. The removed area is casted-in-place with concrete C 30/37 and the uncovered asphalt is renewed.

NOTA GENERALA VALABILA PENTRU INTREGUL PROIECT:
 Executantul este obligat sa verifice informatiile din planuri si din extrasele de materiale inainte de comandarea oricaror materiale si sa comunice orice neconcordanta proiectantului in caz contrar proiectantului nu isi va asuma responsabilitatea pentru nica o eroare din planuri sau din extrasele de materiale.

UNIVERSAL REMARK VALID FOR THE ENTIRE PROJECT:
 The executants is bound to verify all the information from the plans and from the material lists before ordering any materials and to communicate any disparity to the designer. Other way the designer will not assume the responsibility about the errors in the plans or in the material lists.

Extras de armatura / buc. stalp electrificare
 Reinforcement extract / pcs. electrification pole

Marca/ Mark	Diametrul/ Diameter (mm)	Nr. Buc./ No. of pieces	Lungime/ Length (m)	Ø8	Ø10	Ø12
1	8	95	1.30	123.50	-	-
2	10	13	3.25	-	42.25	-
3	10	13	3.60	-	46.80	-
4	12	12	1.30	-	-	15.60
5	10	7	2.00	-	14.00	-
5'	10	7	3.30	-	23.10	-
6	10	13	1.45	-	18.85	-
7	8	13	0.75	9.75	-	-
8	8	28	0.30	8.40	-	-
9	10	9	3.62	-	32.58	-
9'	10	3	2.45	-	7.35	-
10	10	2	3.76	-	7.52	-
10'	10	2	2.52	-	5.04	-
11	10	18	1.51	-	27.18	-
11'	10	18	1.76	-	31.68	-
12	10	24	1.71	-	41.04	-
13	10	9	5.65	-	50.85	-
Lungime totala pe diametre / Total length on diameter (m)				141.65	145.00	15.60
Masa pe metru /Mass on meter (kg/m)				0.395	0.617	0.888
Masa pe diametre / Mass on diameter				55.95	89.47	13.85
Masa totala pe tip de oțel / Total mass on steel type (kg)				159		

CLASA DE IMPORTANTA A CONSTRUCTIEI CONFORM P100/1-2006 ESTE III; CATEGORIA DE IMPORTANTA CONFORM H.G. NR. 768/97 ESTE "C".
THE CONSTRUCTION IMPORTANCE CLASS, ACCORDING TO P100/1-2006 IS III; CATEGORY, ACCORDING TO H.G. 768/97 IS "C".

PROJECTANT / DESIGNER:
 C. Teodorescu
PROIECTANT / SUBCONTRACTOR:
 A.M. Baicu
 D. Oprea
VERIFICAT / CHECKED:
 R. Witan
VERIFICAT / CHECKED:
 M. Ionescu
APROBAT / APPROVED:
 A.M. Baicu
APROBAT / APPROVED:
 D. Oprea
DATA / DATE:
 01.2013
DATA / DATE:
 01.2013
SEMNAȚURA / SIGNATURE:
 C. Teodorescu
SEMNAȚURA / SIGNATURE:
 A.M. Baicu
SEMNAȚURA / SIGNATURE:
 D. Oprea

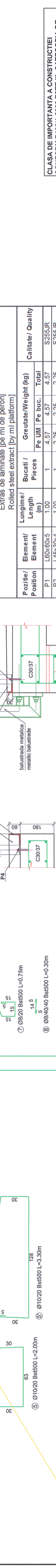
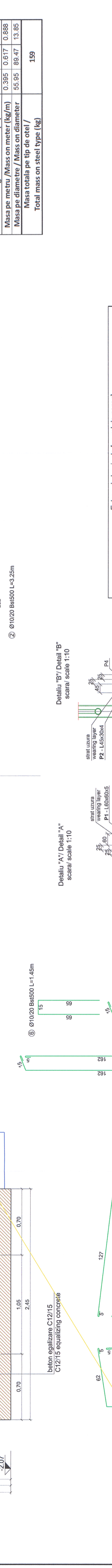

Extras de armatura / buc. stalp electrificare
 Reinforcement extract / pcs. electrification pole

Marca/ Mark	Diametrul/ Diameter (mm)	Nr. Buc./ No. of pieces	Lungime/ Length (m)	Ø8	Ø10	Ø12
1	8	95	1.30	123.50	-	-
2	10	13	3.25	-	42.25	-
3	10	13	3.60	-	46.80	-
4	12	12	1.30	-	-	15.60
5	10	7	2.00	-	14.00	-
5'	10	7	3.30	-	23.10	-
6	10	13	1.45	-	18.85	-
7	8	13	0.75	9.75	-	-
8	8	28	0.30	8.40	-	-
9	10	9	3.62	-	32.58	-
9'	10	3	2.45	-	7.35	-
10	10	2	3.76	-	7.52	-
10'	10	2	2.52	-	5.04	-
11	10	18	1.51	-	27.18	-
11'	10	18	1.76	-	31.68	-
12	10	24	1.71	-	41.04	-
13	10	9	5.65	-	50.85	-
Lungime totala pe diametre / Total length on diameter (m)				141.65	145.00	15.60
Masa pe metru /Mass on meter (kg/m)				0.395	0.617	0.888
Masa pe diametre / Mass on diameter				55.95	89.47	13.85
Masa totala pe tip de oțel / Total mass on steel type (kg)				159		

CLASA DE IMPORTANTA A CONSTRUCTIEI CONFORM P100/1-2006 ESTE III; CATEGORIA DE IMPORTANTA CONFORM H.G. NR. 768/97 ESTE "C".
THE CONSTRUCTION IMPORTANCE CLASS, ACCORDING TO P100/1-2006 IS III; CATEGORY, ACCORDING TO H.G. 768/97 IS "C".

PROJECTANT / DESIGNER:
 C. Teodorescu
PROIECTANT / SUBCONTRACTOR:
 A.M. Baicu
 D. Oprea
VERIFICAT / CHECKED:
 R. Witan
VERIFICAT / CHECKED:
 M. Ionescu
APROBAT / APPROVED:
 A.M. Baicu
APROBAT / APPROVED:
 D. Oprea
DATA / DATE:
 01.2013
DATA / DATE:
 01.2013
SEMNAȚURA / SIGNATURE:
 C. Teodorescu
SEMNAȚURA / SIGNATURE:
 A.M. Baicu
SEMNAȚURA / SIGNATURE:
 D. Oprea

